

METAL PANEL SYSTEMS

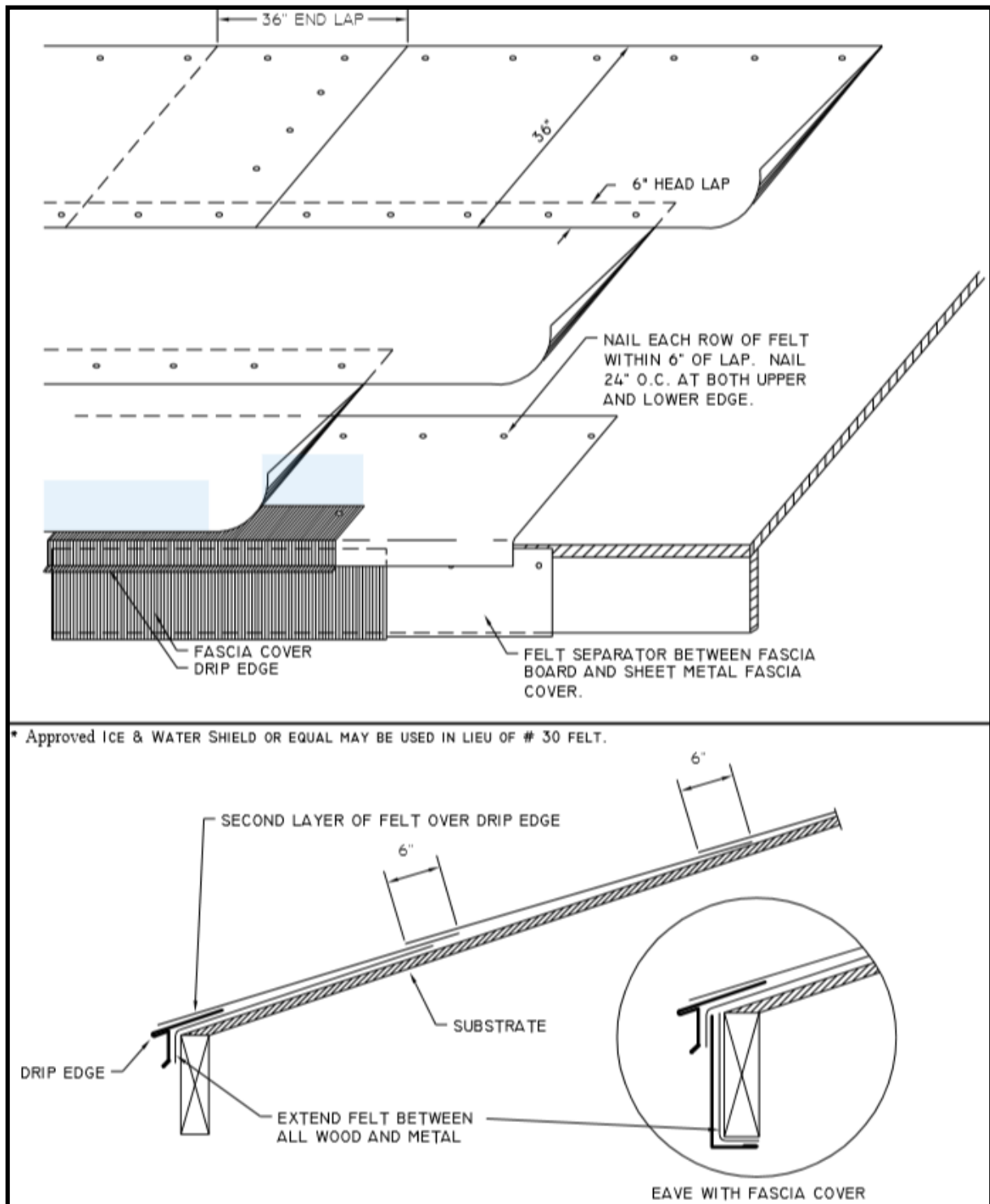

Description:	EAVE AND FIELD FELT	Detail Number:	UND-01
Substrate:	PLYWOOD SHEATHING	Date:	1/20/2020

Details and instructions subject to change without notice. Contact MPS for specific project details.

Metal Panel Systems | 11401 Rockfield Court, Cincinnati, OH 45241 | metalpanelsystems.com | 513-554-6120

METAL PANEL SYSTEMS

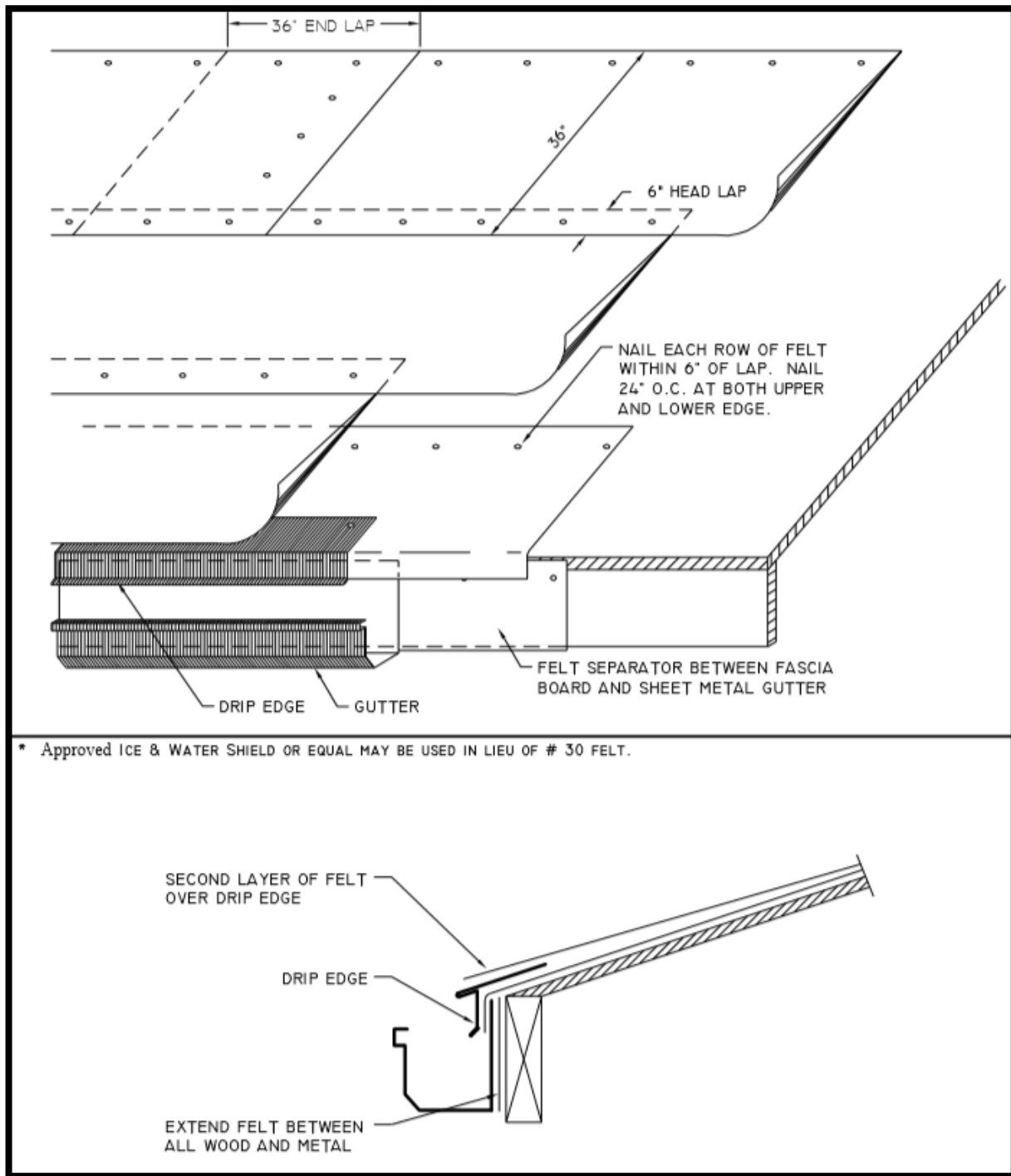

Description:	EAVE WITH GUTTER	Detail Number:	UND-02
Substrate:	PLYWOOD SHEATHING	Date:	1/20/2020

Details and instructions subject to change without notice. Contact MPS for specific project details.

Metal Panel Systems | 11401 Rockfield Court, Cincinnati, OH 45241 | metalpanelsystems.com | 513-554-6120

METAL PANEL SYSTEMS

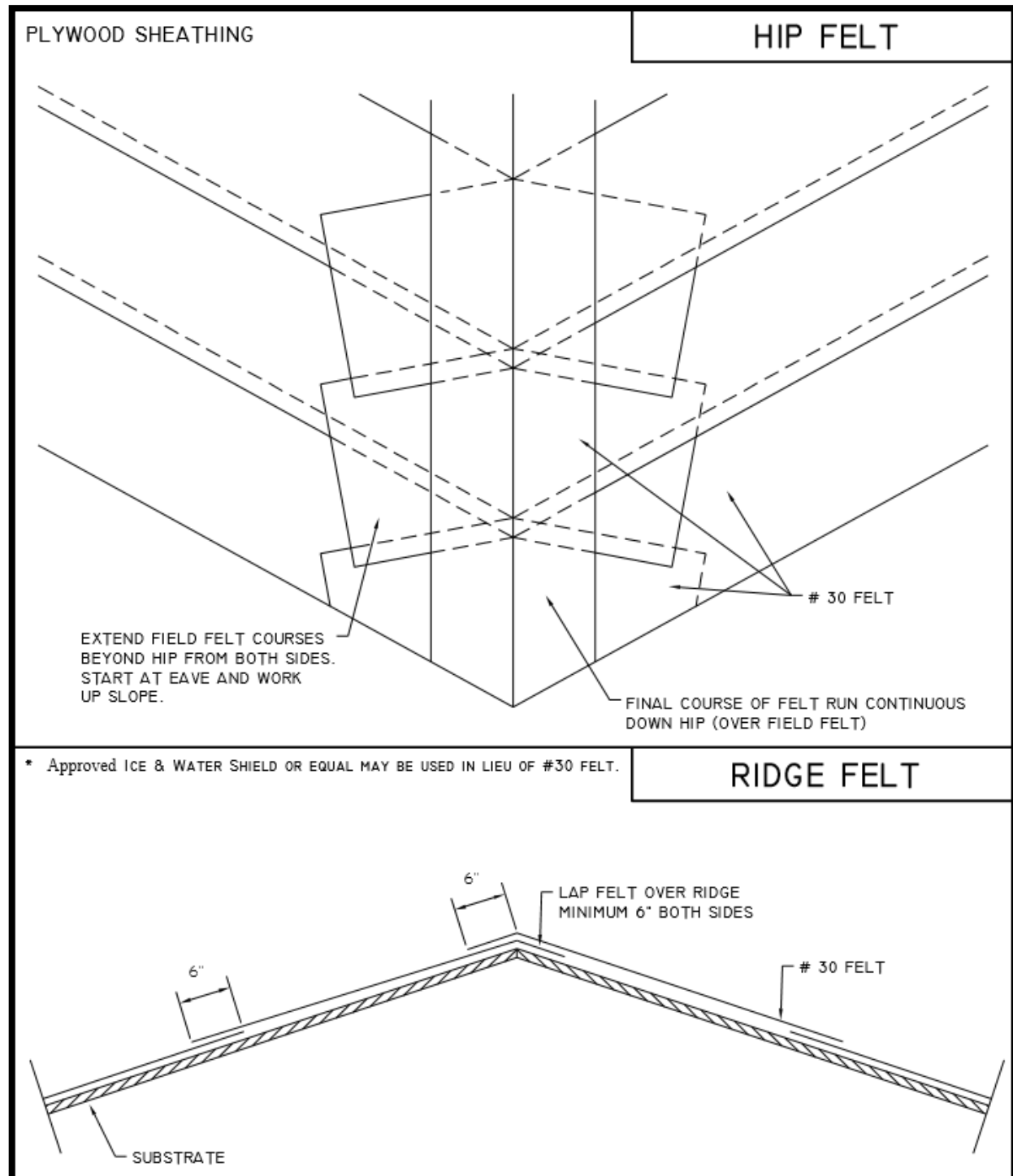

Description:	HIP AND RIDGE FELT	Detail Number:	UND-03
Substrate:	PLYWOOD SHEATHING	Date:	1/20/2020

Details and instructions subject to change without notice. Contact MPS for specific project details.

METAL PANEL SYSTEMS

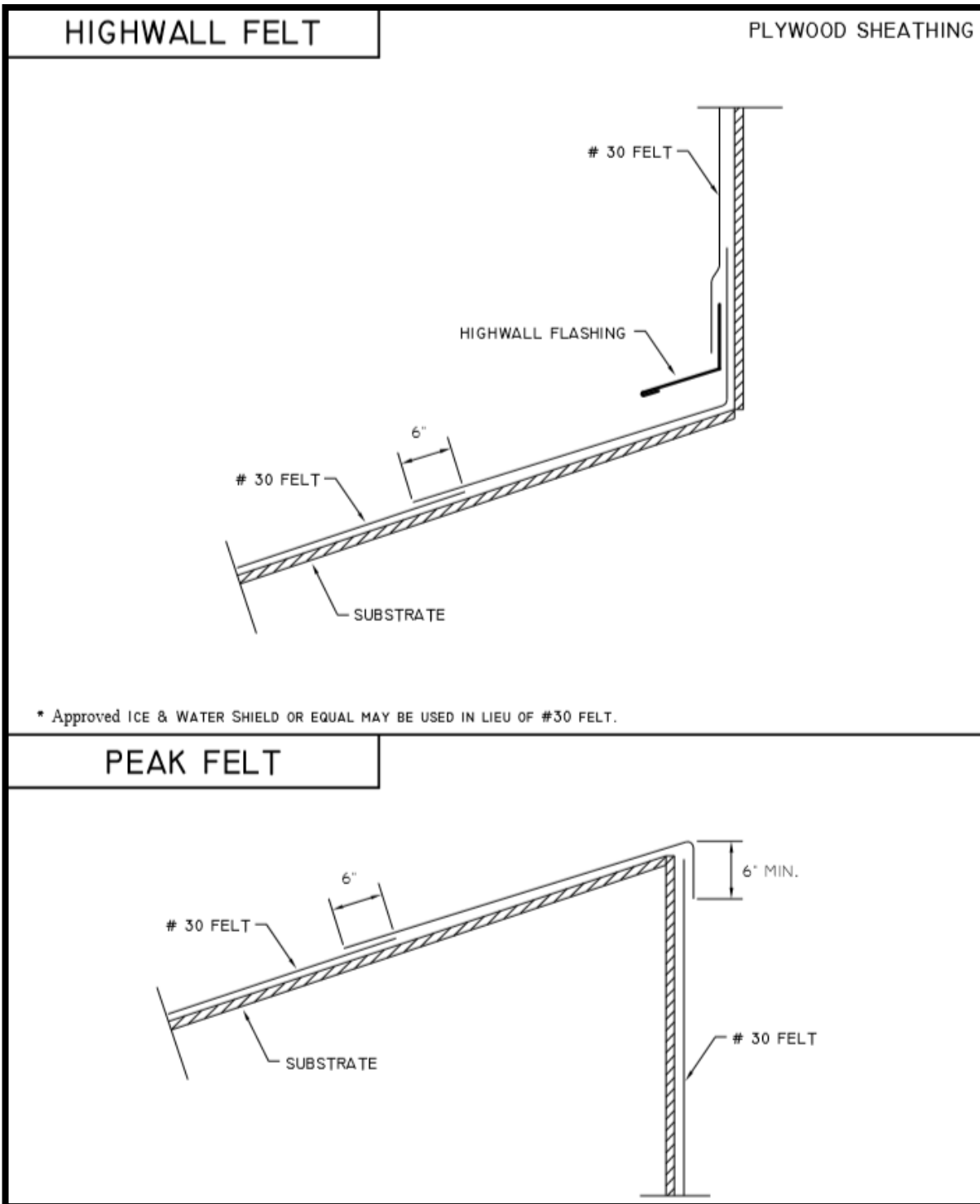

* Approved ICE & WATER SHIELD OR EQUAL MAY BE USED IN LIEU OF #30 FELT.



Description:	HIGHWALL AND PEAK FELT	Detail Number:	UND-04
Substrate:	PLYWOOD SHEATHING	Date:	1/20/2020

Details and instructions subject to change without notice. Contact MPS for specific project details.

Metal Panel Systems | 11401 Rockfield Court, Cincinnati, OH 45241 | metalpanelsystems.com | 513-554-6120

METAL PANEL SYSTEMS

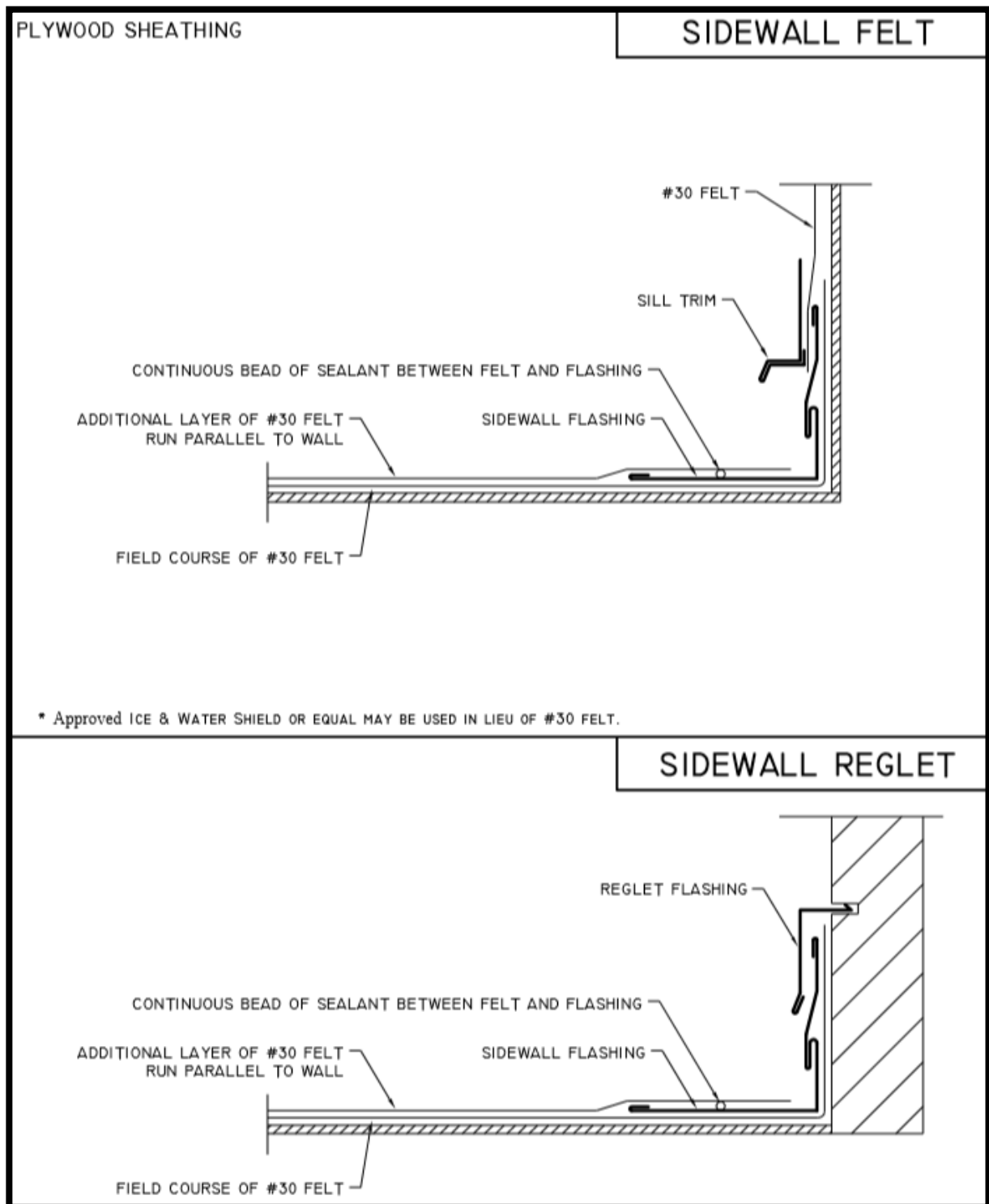

Description: SIDEWALL FELT AND REGLET

Detail Number: UND-05

Substrate: PLYWOOD SHEATHING

Date: 1/20/2020

Details and instructions subject to change without notice. Contact MPS for specific project details.

Metal Panel Systems | 11401 Rockfield Court, Cincinnati, OH 45241 | metalpanelsystems.com | 513-554-6120

METAL PANEL SYSTEMS

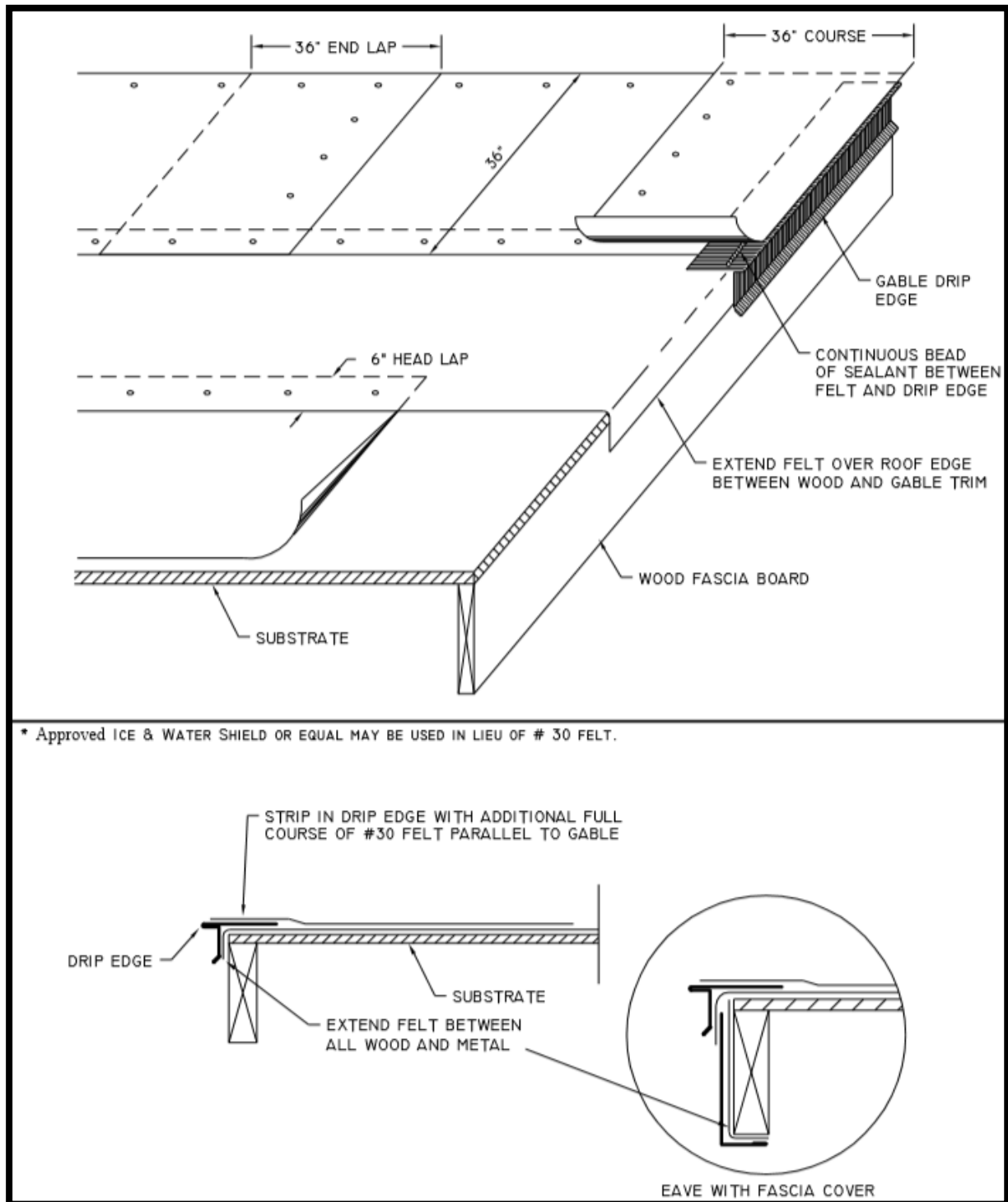

Description:	GABLE FELT	Detail Number:	UND-06
Substrate:	PLYWOOD SHEATHING	Date:	1/20/2020

Details and instructions subject to change without notice. Contact MPS for specific project details.

METAL PANEL SYSTEMS

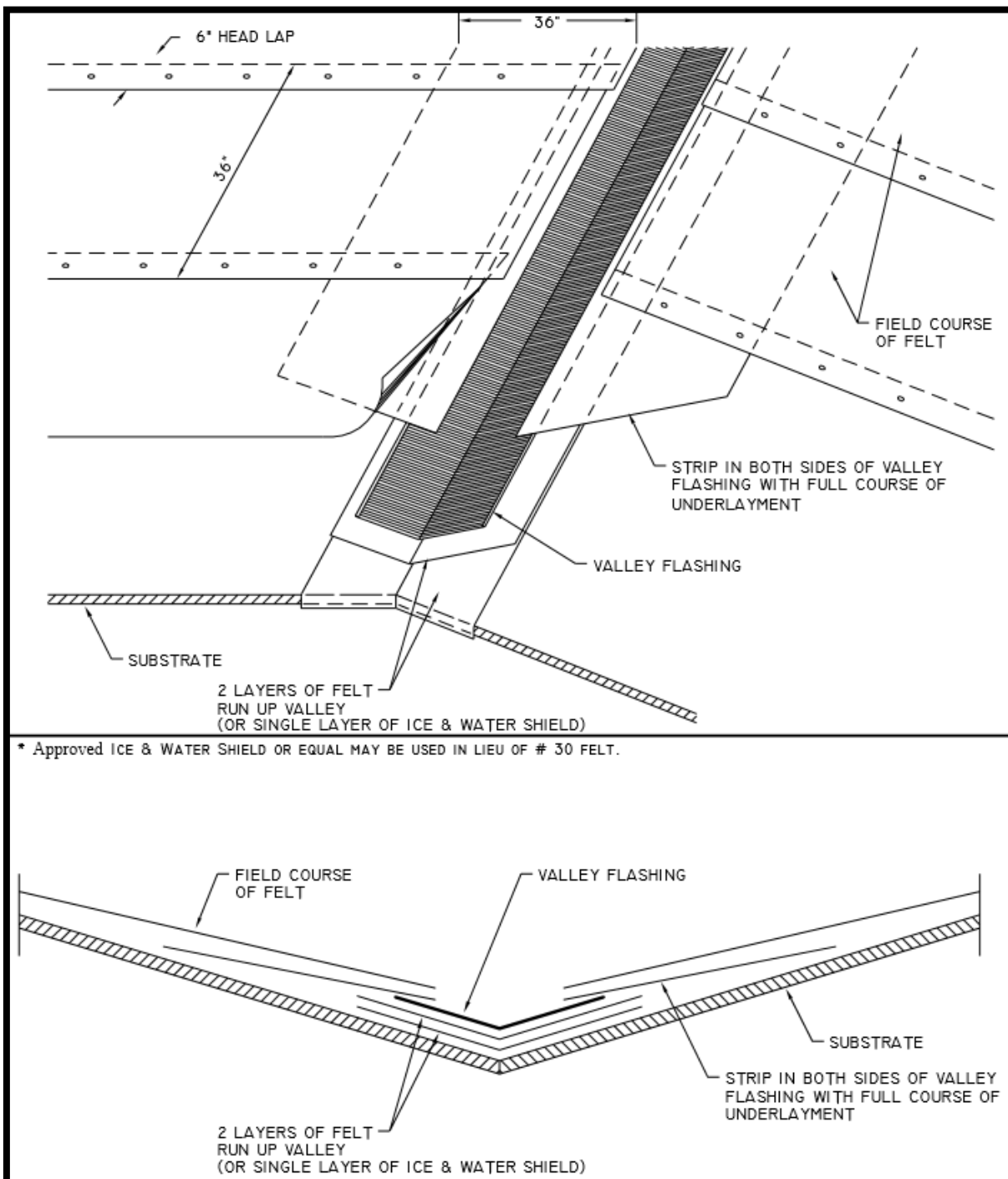

Description:	VALLEY FELT	Detail Number:	UND-07
Substrate:	PLYWOOD SHEATHING	Date:	1/20/2020

Details and instructions subject to change without notice. Contact MPS for specific project details.